

throttle check valve, screw-in type (adjustable)

FCV7-10.-.-0-..

MF-440-100-00

(subject to change)

FAT-N



HEX 3/4"

HEX 1"
(torque
cartridge:
48 - 54 Nm)

cavity:
C-10-2
see
data-sheet no.:
IK-100-109-00

HEX 3/16"

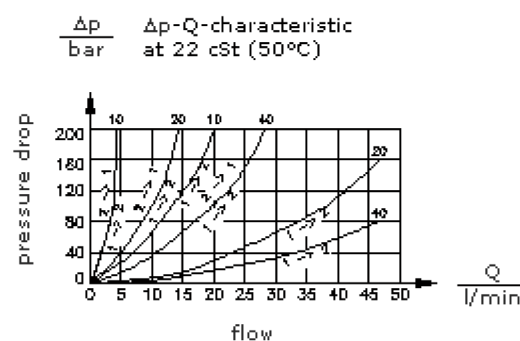
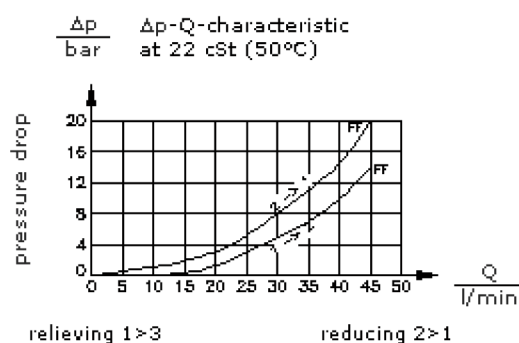
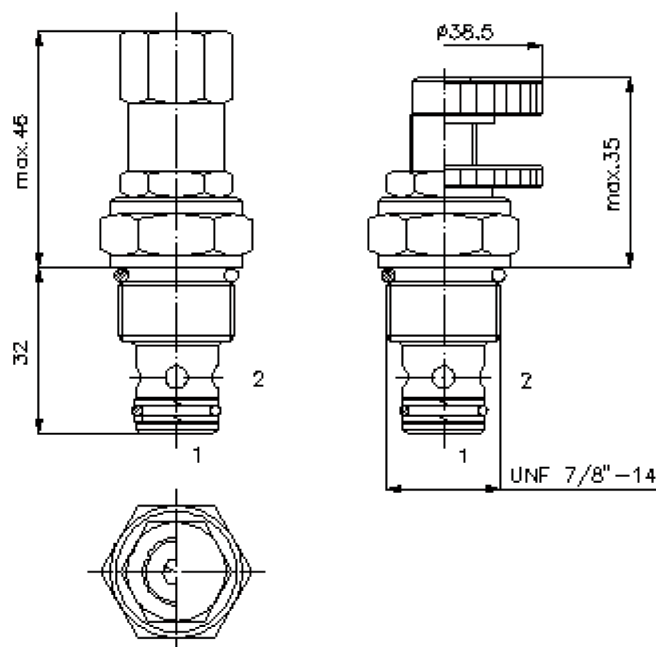

throttle check valve, screw-in type (adjustable)

FCV7-10.-.-0-..



Motrac Hydraulik GmbH
Siemensring 87 - D-47877 Willich
fon +49-(0)2154-8162.0 - fax +49-(0)2154-8162.499
e-mail info.miw@motracindustries.com
internet www.motracindustries.com

MF-440-100-00

(subject to change)

Ordering example:

FCV7 - 10N - C - 0 - FF
| | | | |
A **B** **C** **D** **E**

Model code:

- A design**
throttle check valve
- B size and sealing**
10N = Buna (NBR)
10V = Viton (FPM)
- C adjustment**
S = screw adjustment
C = cap
K = handknob

- D construction**
0 = screw-in valve
- E controlled flow option**
FF = throttle-check-valve
10 = flow range see diagram
20 = flow range see diagram
40 = flow range see diagram

Technical Data:

nominal pressure:	210 bar
nominal flow:	45 l/min
weight:	0.11 kg
temperature range:	-40°C to 120°C
fluids:	hydraulic oil as per DIN 51524 T1 (ISO TC 131)
seals:	optional Buna (NBR) or Viton (FPM), as well as Teflon wascher (PTFE)
cavity:	C-10-2 see datasheet no. IK-100-109-00
housing:	2LH-10.-B.. see datasheet no. IH-100-000-00
seal kit:	SP-MDS-10N-22 (NBR), SP-MDS-10V-22 (FPM)