

2-way flow control screw-in valve (fixed)

FR5-08.-F-0-.....

FAT-N

MF-110-081-00

(subject to change)

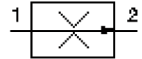

HEX 7/8"
(torque
cartridge:
34 - 40 Nm)

cavity:
C-08-2
see
data-sheet no.:
[IK-100-089-00](#)

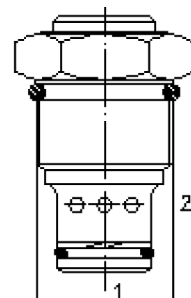
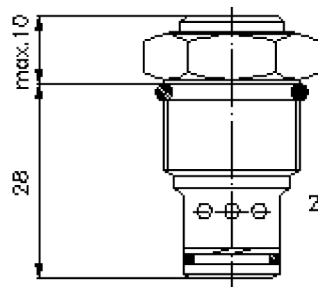

UNF 3/4" -16-2B

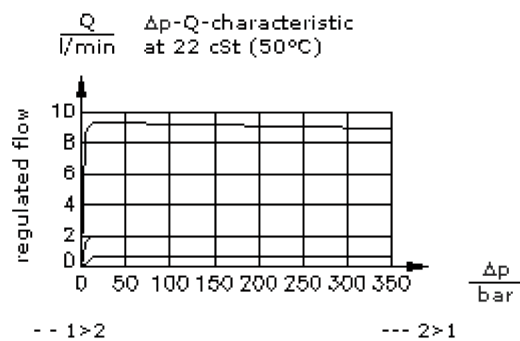
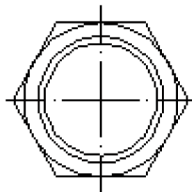

2-way flow control screw-in valve (fixed)

FR5-08.-F-0-.....



Motrac Hydraulik GmbH
Siemensring 87 - D-47877 Willich
fon +49-(0)2154-8162.0 - fax +49-(0)2154-8162.499
e-mail info.miw@motracindustries.com
internet www.motracindustries.com

FAT•N

MF-110-081-00

(subject to change)

Ordering example:

FR5 - 08N - F - 0 - 02.00
| | | | |
A **B** **C** **D** **E**

Model code:

- | | |
|--|--|
| <p>A design
flow regulator valve</p> <p>B size and sealing
08N = Buna (NBR)
08V = Viton (FPM)</p> <p>C adjustment
F = fixed</p> <p>D construction
0 = screw-in valve</p> | <p>E quantity adjustment
requested regulated flow
Q specify in gpm
1 l/min = 0.265 Gpm
(1 Gpm = 3.785 l/min)
regulation tolerance
0.5 - 2.0 l/min ±20% (210 bar)
0.5 - 2.0 l/min ±40% (350 bar)
2.0 - 6.0 l/min ±15%
6.0 - 10.0 l/min ±10%</p> |
|--|--|

Technical Data:

nominal pressure:	350 bar
nominal flow:	10 l/min
weight:	0.05 kg
temperature range:	-40°C to 120°C
fluids:	hydraulic oil as per DIN 51524 T1 (ISO TC 131)
seals:	optional Buna (NBR) or Viton (FPM), as well as Teflon wascher (PTFE)
cavity:	C-08-2 see datasheet no.: IK-100-089-00
housing:	2LH-08.-B.. see datasheet no.: IH-100-000-00
seal kit:	SP-MDS-08N-21 (NBR), SP-MDS-08V-21 (FPM)