

base block, stack valve, CETOP 5 (with relief valve, RV5-10, electric discharge)

MBS-10.-B32/B..-05...-.....



Motrac Hydraulik GmbH
Siemensring 87 - D-47877 Willich
fon +49-(0)2154-8162.0 - fax +49-(0)2154-8162.499
e-mail info.mhw@motrac-hydraulics.com
internet www.motrac-hydraulics.com

IM-512-203-00

(subject to change)

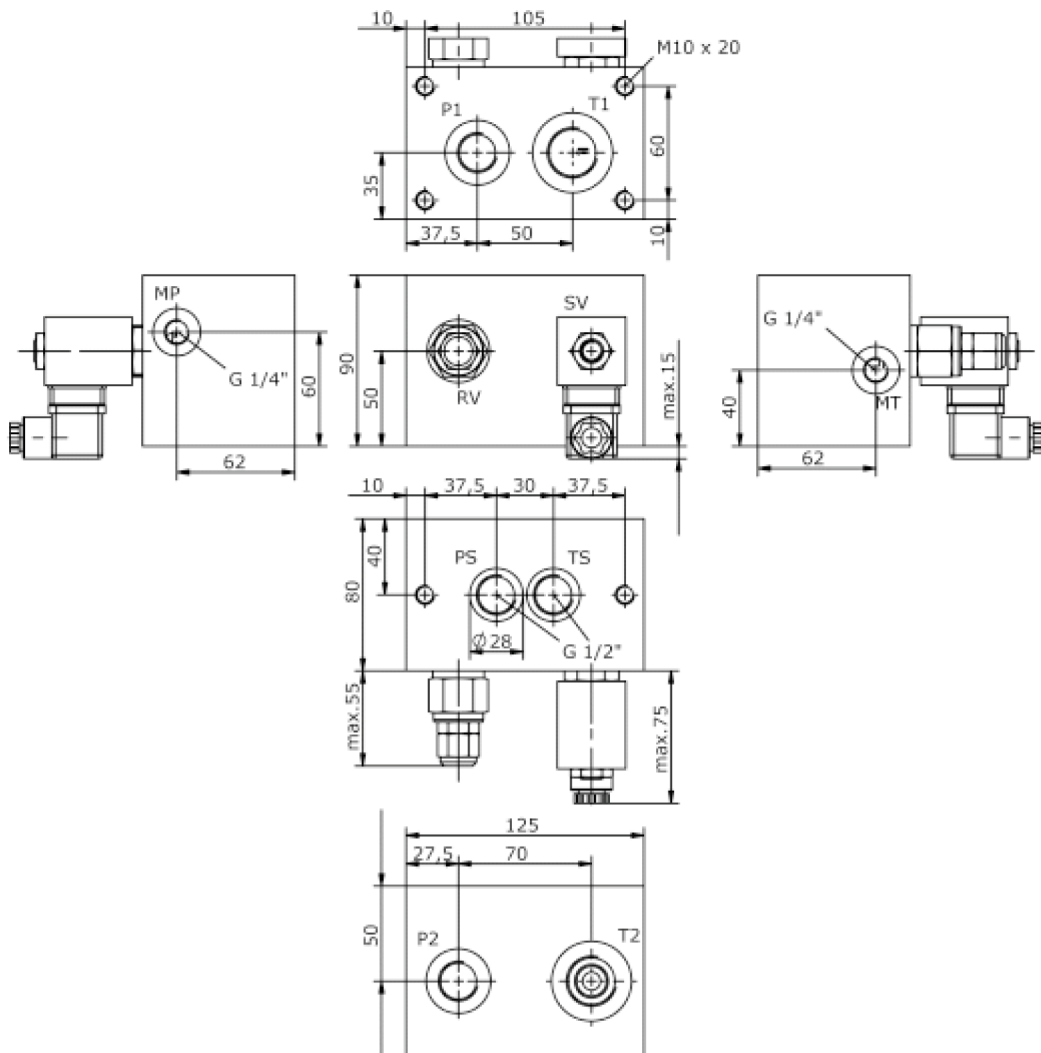
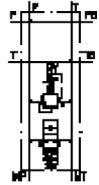

base block, stack valve, CETOP 5 (with relief valve, RV5-10, electric discharge)

MBS-10.-B32/B..-05...-.....



Motrac Hydraulik GmbH
Siemensring 87 - D-47877 Willich
fon +49-(0)2154-8162.0 - fax +49-(0)2154-8162.499
e-mail info.mhw@motrac-hydraulics.com
internet www.motrac-hydraulics.com

IM-512-203-00

(subject to change)

Ordering example:

MBS - 10A - B32 / B06 - 05 - C - 20 - 11 - C - 024D - G

A
 B
 C
 D
 E
 F
 G
 H
 I
 J
 K

Model code:

- | | |
|---|--|
| <p>A design
IMAV-stack system</p> <p>B size and material
10A = aluminum (F37)
10S = steel (9SMnPb28K resp. GGG-40)</p> <p>C base manifold
base block</p> <p>D port size P and T
B04 = P: BSPP 1/2" and T: BSPP 3/4"
B06 = P: BSPP 3/4" and T: BSPP 1"</p> <p>E relief valve
05 = RV5-10.-.. (direct acting) see data sheet no.: MP-170-101-00
PS = RVPS-10.-.. (pilot operated) see data sheet no.: CP-110-101-00</p> <p>F adjustment
J = internal (only RV5)
C = cap
K = handknob
S = screw adjustment</p> <p>G pressure range
RV5-10.-..
03 = 3.5 - 20 bar
20 = 7.0 - 140 bar
35 = 17.0 - 240 bar
RVPS-10.-..
15 = 3.4 - 100 bar
30 = 3.4 - 210 bar
50 = 3.4 - 350 bar</p> | <p>H 2-way solenoid valve
03 = SV3-10.- .. see data sheet no.: MS-240-100-00 resp. MS-430-100-00
11 = SBV11-10.-.. see data sheet no.: MS-260-101-00 resp. MS-460-101-00</p> <p>I symbol function mode
C = normally closed
0 = normally open</p> <p>J voltage
DC current:
012D = 12V DC
024D = 24V DC
AC current:
120A = 120V AC
240A = 240V AC
other voltage on request</p> <p>K power supply
G = DIN 43650 connector, other connectors see data sheet no.: MS-010-000-00</p> |
|---|--|

Technical Data:

nominal pressure: 210 bar (A)
350 bar (S)

weight: 2.3 / 4.9 kg (A/S)

included: included
2 pcs. O-Ring 21.82 x 3.53